

STATE	STATE PROJECT REFERENCE NO.	SHEET NO.	TOTAL SHEETS
N.C.	17BP.2.R.94	1	
STATE PROJ. NO.	F.A. PROJ. NO.	DESCRIPTION	
17BP.2.PE.94	N/A	PE	
17BP.2.PE.94	N/A	RW & UTILITIES	
17BP.2.R.94	N/A	CONST.	

STATE OF NORTH CAROLINA
DIVISION OF HIGHWAYS
PAMLICO COUNTY

BUFFER DRAWING SHEET 1 OF 7

LOCATION: BRIDGE NO.14 ON SR 1005 (NEUSE ROAD) OVER BEARD CREEK
TYPE OF WORK: GRADING, DRAINAGE, PAVING, AND STRUCTURE

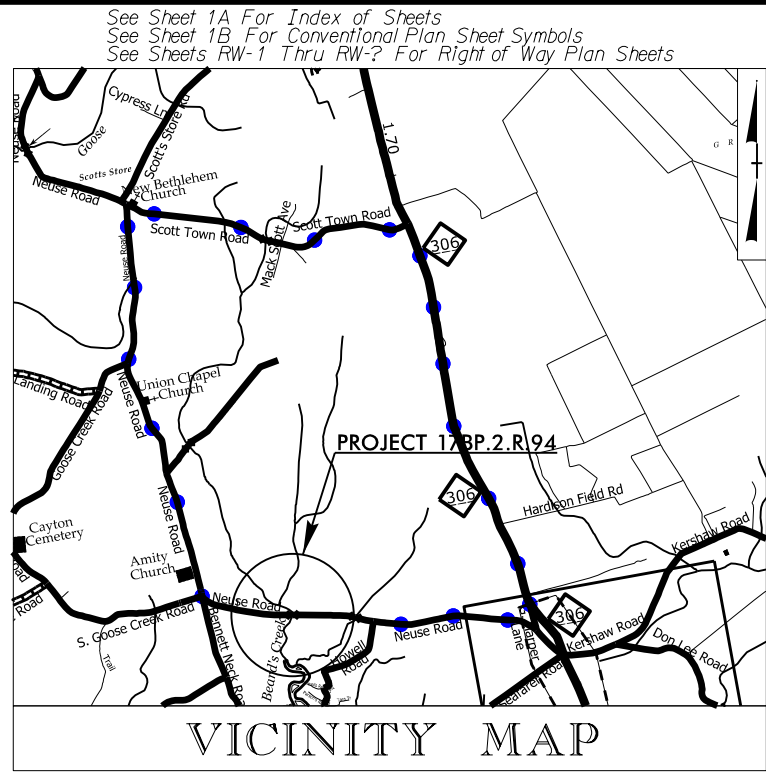

VICINITY MAP

●●●●●●●●
DETOUR ROUTE

25% PLANS

BUFFER IMPACTS PERMIT

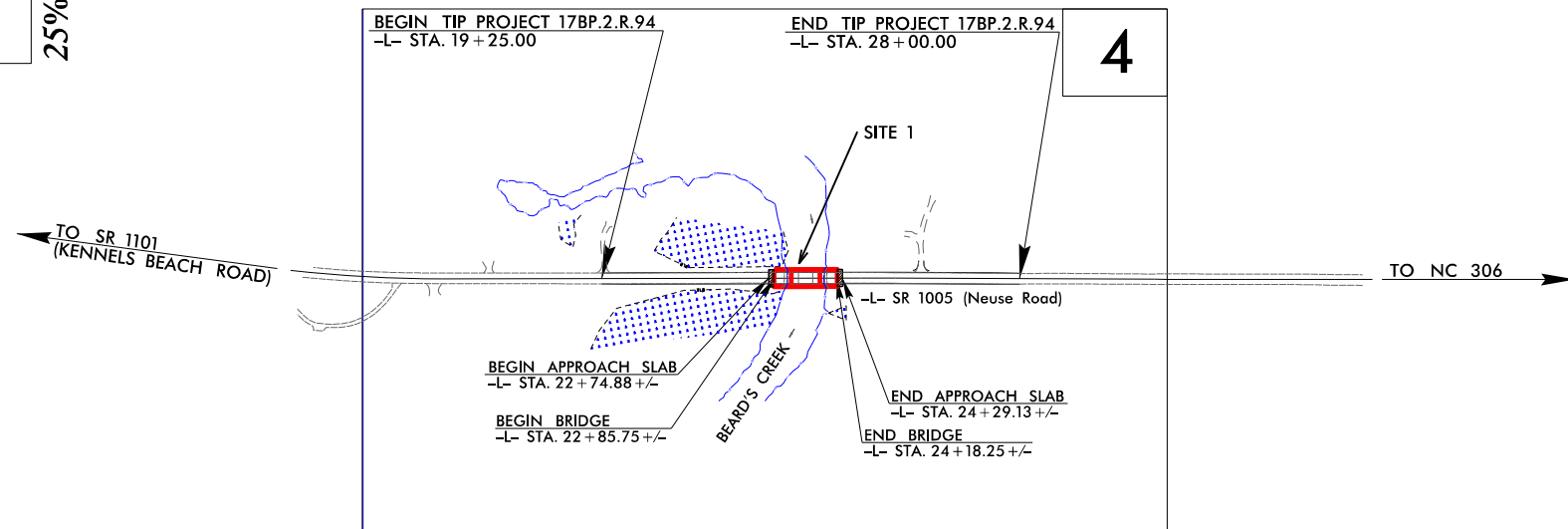

INCOMPLETE PLANS
DO NOT USE FOR R/W ACQUISITION
DOCUMENT NOT CONSIDERED FINAL
UNLESS ALL SIGNATURES COMPLETED

THIS PROJECT IS NOT WITHIN ANY MUNICIPAL BOUNDARIES.
CLEARING ON THIS PROJECT SHALL BE PERFORMED TO THE LIMITS ESTABLISHED BY METHOD II.

CONTRACT:

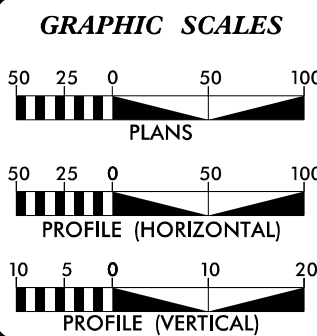

DESIGN DATA

ADT 2022 =	915
ADT 2040 =	1,600
K =	— %
D =	— %
T =	6 % *
V =	60 MPH
* TTST =	DUAL =
FUNC CLASS =	MINOR COLLECTOR
	"SUB-REGIONAL TIER"

PROJECT LENGTH

LENGTH ROADWAY TIP PROJECT 17BP.2.R.94 =	0.141 MILES
LENGTH STRUCTURE TIP PROJECT 17BP.2.R.94 =	0.025 MILES
TOTAL LENGTH TIP PROJECT 17BP.2.R.94 =	0.166 MILES

Prepared In the Office of:

SEPI
Engineering & Construction, Inc.
1 Glenwood Avenue
Raleigh, NC 27603
Tel: 919.789.9977
Fax: 919.789.9591
License: C-2197

2018 STANDARD SPECIFICATIONS

RIGHT OF WAY DATE:
JUNE 21, 2022

LETTING DATE:
SEPTEMBER 28, 2022

RAJIT RAMKUMAR, PE
PROJECT ENGINEER

DANIEL W. GARDNER, JR., PE
PROJECT DESIGN ENGINEER

MICHAEL AMAN, PE
NCDOT CONTACT

HYDRAULICS ENGINEER

SIGNATURE: _____ P.E.

ROADWAY DESIGN ENGINEER

SIGNATURE: _____ P.E.

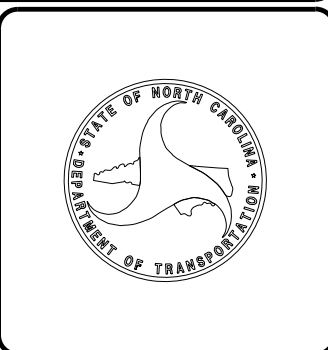

9/19/2022 9:45:55 AM Rdy_tsh_buf.dgn USER:tovrby

6/2/99

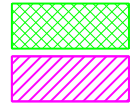

ALLOWABLE IMPACTS ZONE 1
ALLOWABLE IMPACTS ZONE 2

BUFFER DRAWING SHEET 2 OF 7



1 Glenwood Avenue
Raleigh, NC 27603
Tel: 919.789.9977
Fax: 919.789.9591
License: C-2197

PROJECT REFERENCE NO. 17BP.2.PE.94	SHEET NO. 4
ROADWAY DESIGN ENGINEER	HYDRAULICS ENGINEER
INCOMPLETE PLANS DO NOT USE FOR R/W ACQUISITION	
DOCUMENT NOT CONSIDERED FINAL UNLESS ALL SIGNATURES COMPLETED	

NAD 83/95

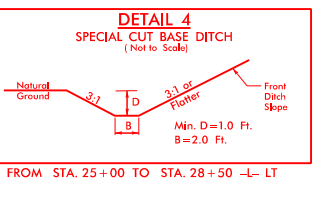
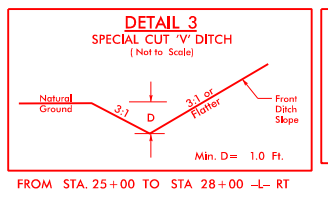
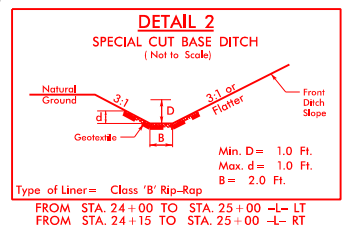
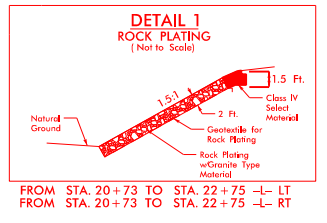
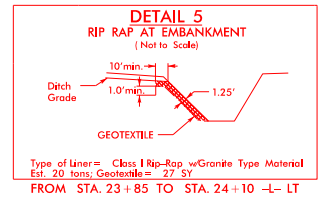
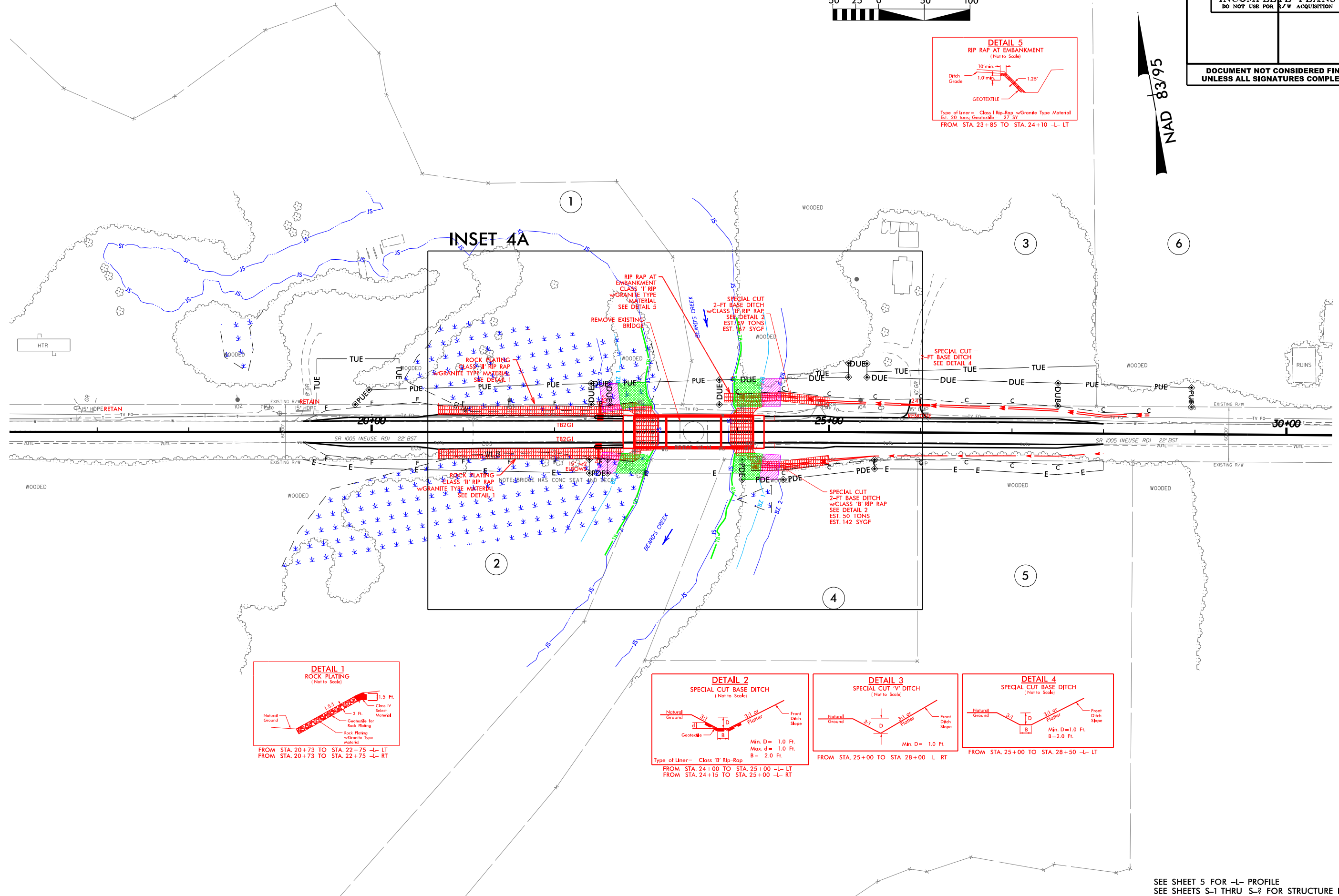

9/18/2006_hyd_prm_buf_PSH4.dgn

SEE SHEET 5 FOR -L- PROFILE
SEE SHEETS S-1 THRU S-2 FOR STRUCTURE PLANS

6/2/99

9/18/2022 hyd_perm_buf_PSH4_Conctours.dgn

ALLOWABLE IMPACTS ZONE 1

ALLOWABLE IMPACTS ZONE 2

BUFFER DRAWING
SHEET 3 OF 7



1 Glenwood Avenue
Raleigh, NC 27603
Tel: 919.789.9977
Fax: 919.789.9591
License: C-2197

PROJECT REFERENCE NO. 17BP.2.PE.94	SHEET NO. 4
ROADWAY DESIGN ENGINEER	HYDRAULICS ENGINEER
INCOMPLETE PLANS DO NOT USE FOR R/W ACQUISITION	

DOCUMENT NOT CONSIDERED FINAL
UNLESS ALL SIGNATURES COMPLETED

NAD 83/95

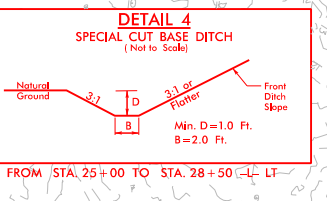
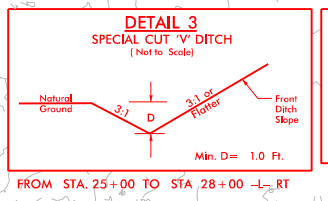
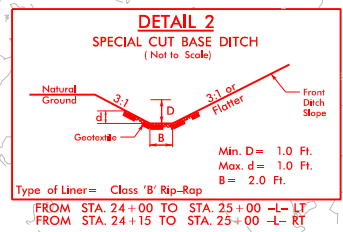
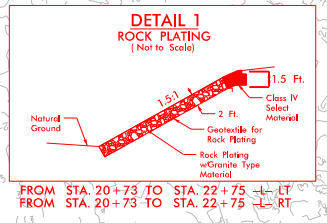
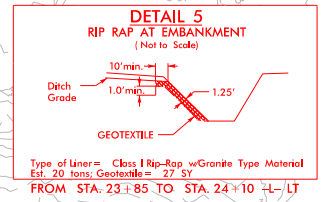
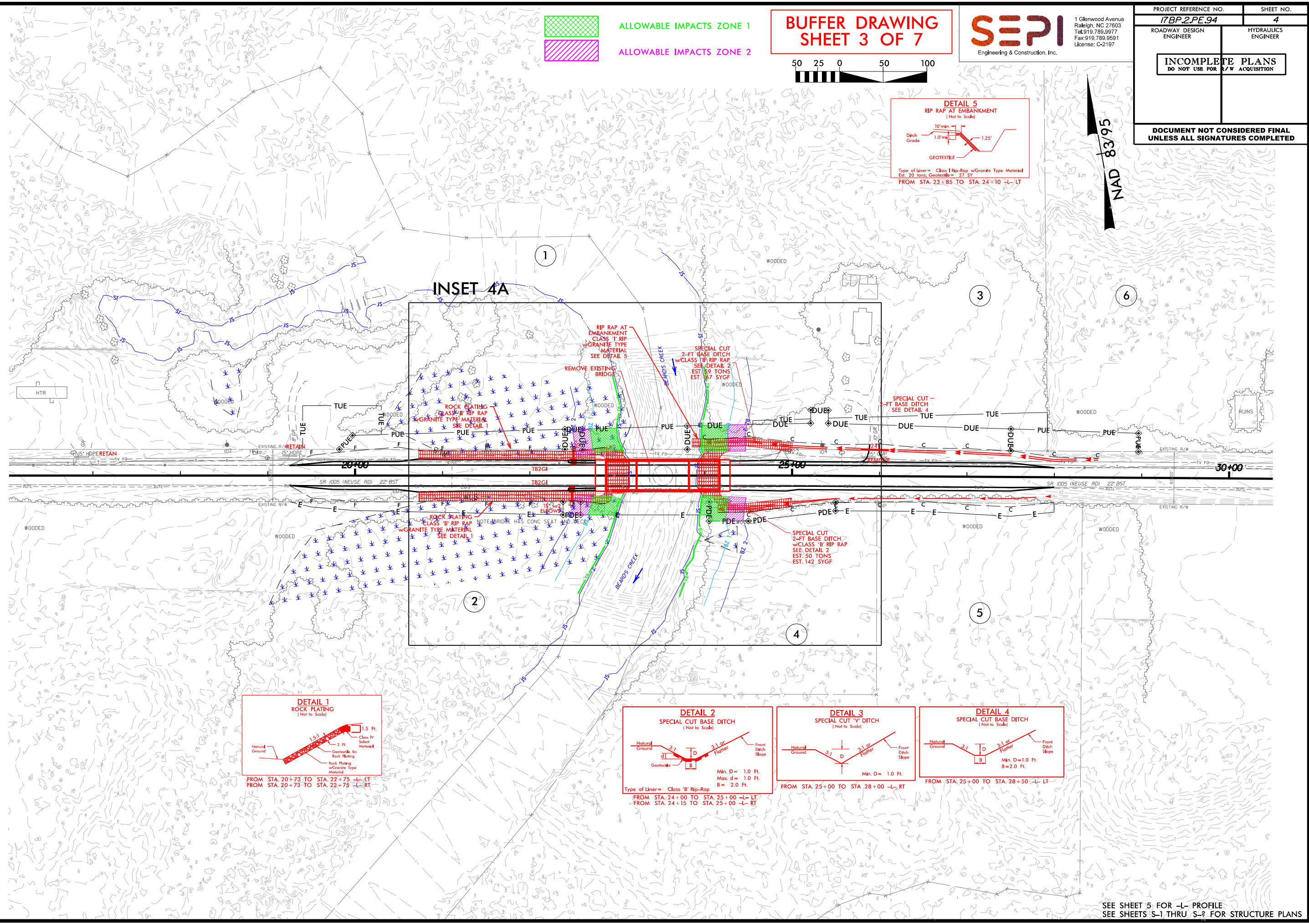

SEE SHEET 5 FOR -L- PROFILE
SEE SHEETS S-1 THRU S-2 FOR STRUCTURE PLANS

6/2/09

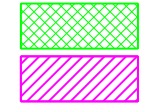
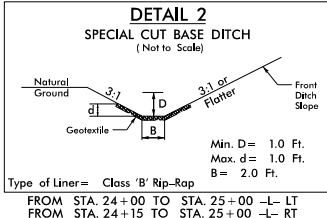
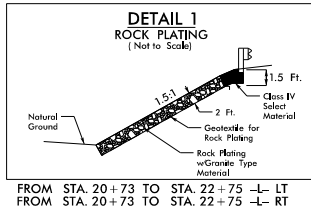

ALLOWABLE IMPACTS ZONE 1
ALLOWABLE IMPACTS ZONE 2

**BUFFER DRAWING
SHEET 4 OF 7**



SEPI
Engineering & Construction, Inc.

1 Glenwood Avenue
Raleigh, NC 27603
Tel: 919.789.9977
Fax: 919.789.9591
License: C-2197

PROJECT REFERENCE NO. 17BP-2.R.94	SHEET NO. 4A
ROADWAY DESIGN ENGINEER	PAVEMENT DESIGN ENGINEER
INCOMPLETE PLANS DO NOT USE FOR A/W ACQUISITION	
DOCUMENT NOT CONSIDERED FINAL UNLESS ALL SIGNATURES COMPLETED	

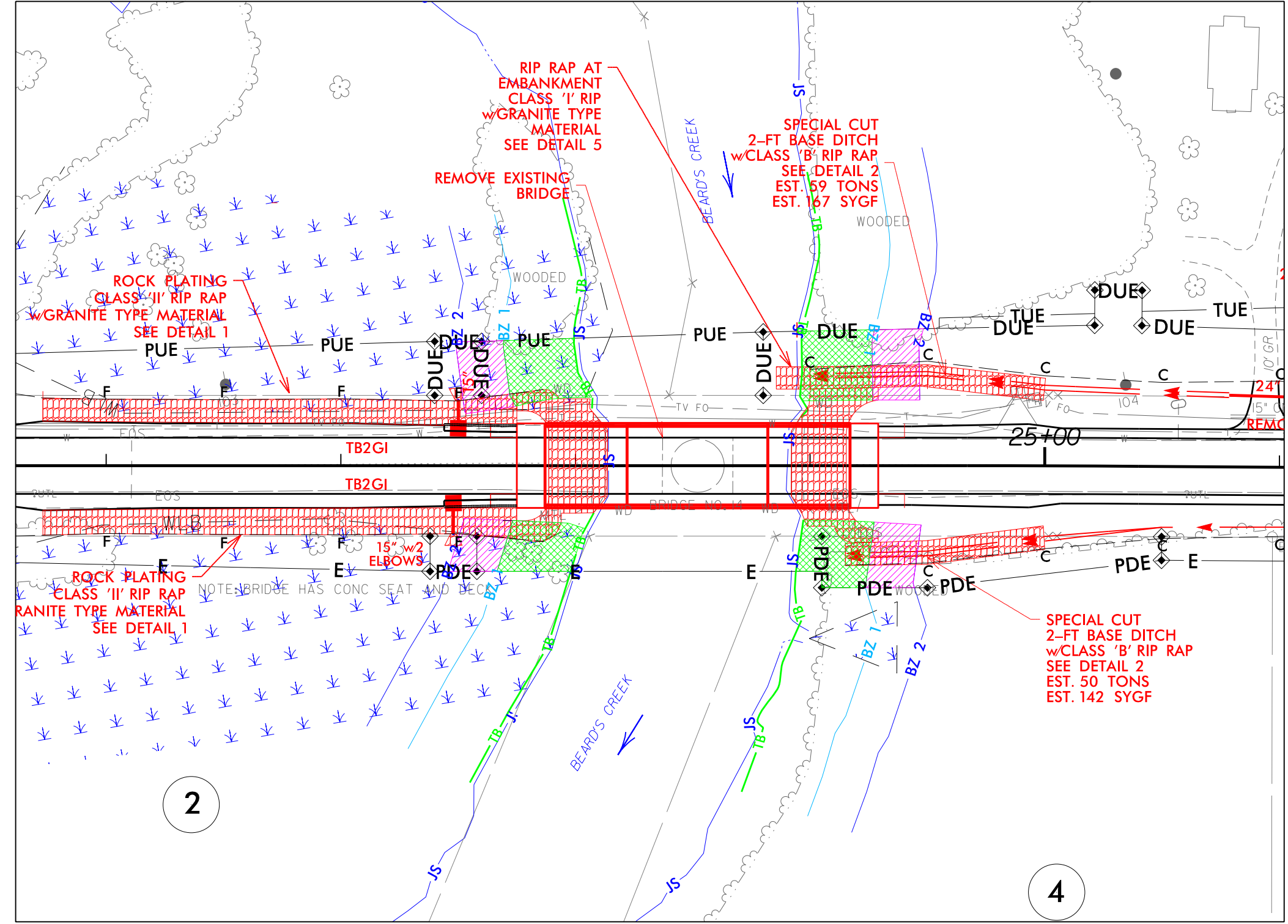

9/18/2009 10:26:56 AM hyd_perm_buf_PSH4A.dgn

6/2/09

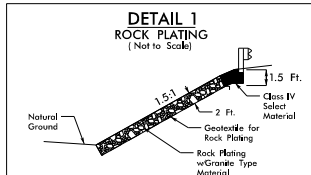

FROM STA. 20+73 TO STA. 22+75 -L- LT
 FROM STA. 20+73 TO STA. 22+75 -L- RT

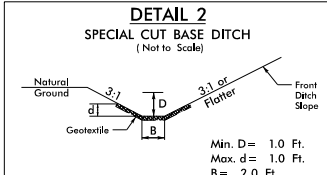

Type of Lining = Class 'B' Rip-Rap
 FROM STA. 24+00 TO STA. 25+00 -L- LT
 FROM STA. 24+15 TO STA. 25+00 -L- RT

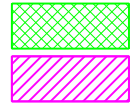

ALLOWABLE IMPACTS ZONE 1

ALLOWABLE IMPACTS ZONE 2

**BUFFER DRAWING
SHEET 5 OF 7**



SEPI
Engineering & Construction, Inc.

1 Glenwood Avenue
Raleigh, NC 27603
Tel: 919.789.9977
Fax: 919.789.9591
License: C-2197

PROJECT REFERENCE NO. 17BP-2.R.94	SHEET NO. 4A
ROADWAY DESIGN ENGINEER	PAVEMENT DESIGN ENGINEER
INCOMPLETE PLANS DO NOT USE FOR A/W ACQUISITION	
DOCUMENT NOT CONSIDERED FINAL UNLESS ALL SIGNATURES COMPLETED	

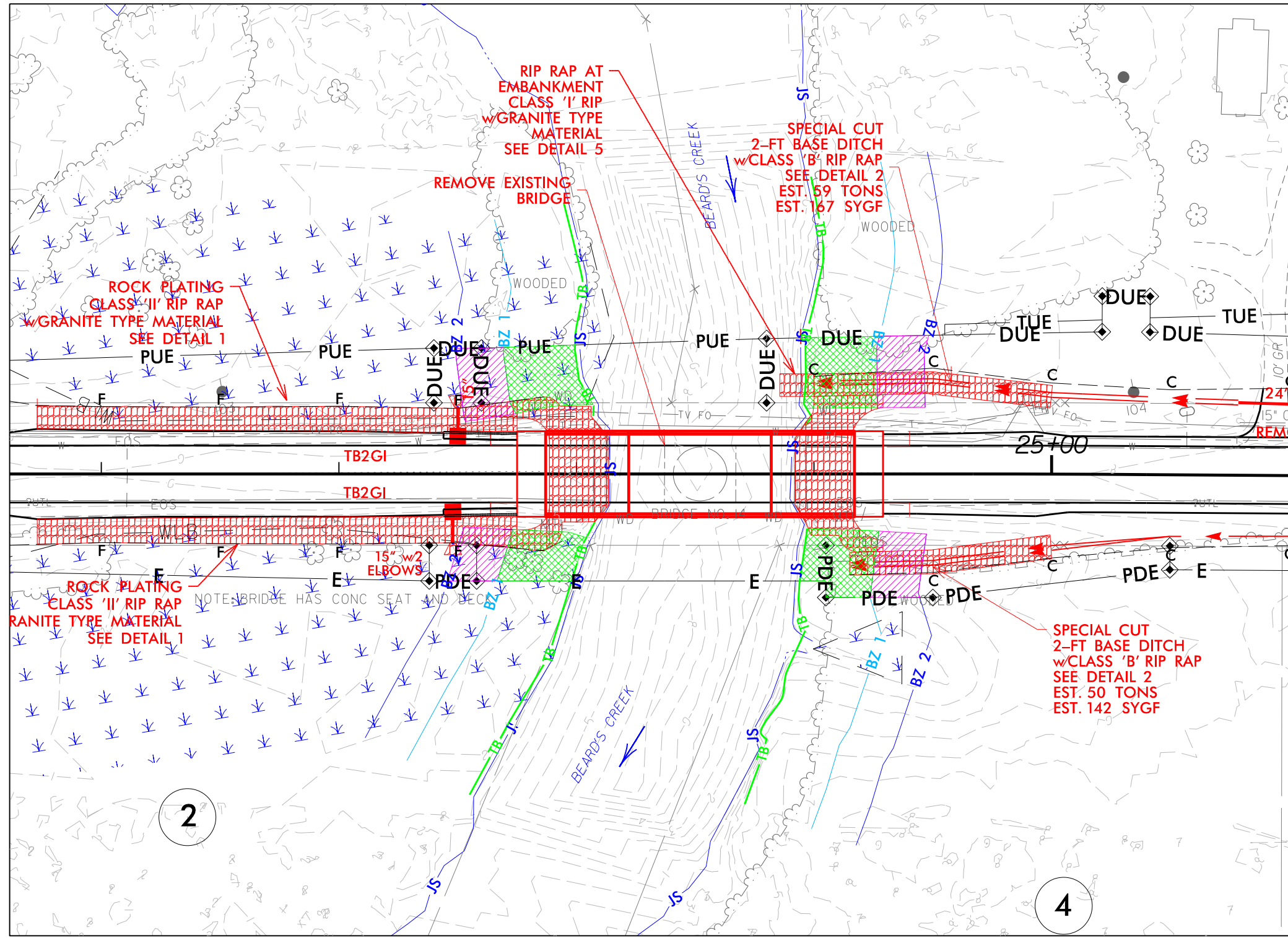

2

4

9/18/2009 10:26:56 hyd_prm_buf_PSH4A_con.tours.dgn

RIPARIAN BUFFER IMPACTS SUMMARY

Site No.	Station (From/To)	Structure Size / Type	IMPACTS									BUFFER REPLACEMENT	
			TYPE			ALLOWABLE			MITIGABLE			ZONE 1 (ft ²)	ZONE 2 (ft ²)
			ROAD CROSSING	BRIDGE	PARALLEL IMPACT	ZONE 1 (ft ²)	ZONE 2 (ft ²)	TOTAL (ft ²)	ZONE 1 (ft ²)	ZONE 2 (ft ²)	TOTAL (ft ²)		
1	22+50 to 22+75 -L- LT	Roadway Fill/Rock Plating	X				598		598				
1	22+70 to 23+06 -L- LT	Bridge Construction		X		809		809					
1	22+46 to 22+73 -L- RT	Roadway Fill/Rock Plating	X				463		463				
1	22+67 to 23+04 -L- RT	Bridge Construction		X		651		651					
1	23+93 to 24+24 -L- LT	Bridge Const./Roadside Ditch		X		903		903					
1	24+24 to 24+45 -L- LT	Roadside Ditch	X				607		607				
1	23+94 to 24+27 -L- RT	Bridge Const./Roadside Ditch		X		787		787					
1	24+24 to 24+47 -L- RT	Roadside Ditch	X				553		553				
TOTALS*:						3150	2221	5371	0	0	0	0	0

NOTES:

NC DEPARTMENT OF TRANSPORTATION
 DIVISION OF HIGHWAYS
 6/20/2022
 Pamlico County
 SF680014
 17BP.2.R.94

WETLANDS IN BUFFER IMPACTS SUMMARY

SITE NO.	STATION (FROM/TO)		WETLANDS IN BUFFERS	
			ZONE 1 (ft ²)	ZONE 2 (ft ²)
1	22+52/23+06	-L- LT	809	590
1	22+48/23+06	-L- RT	481	323
TOTAL:			1290	913

NC DEPARTMENT OF TRANSPORTATION
 DIVISION OF HIGHWAYS
 6/20/2022
 Pamlico County
 SF680014
 17BP.2.R.94
 SHEET 7 OF 7